

USE AND WARNING INSTRUCTIONS

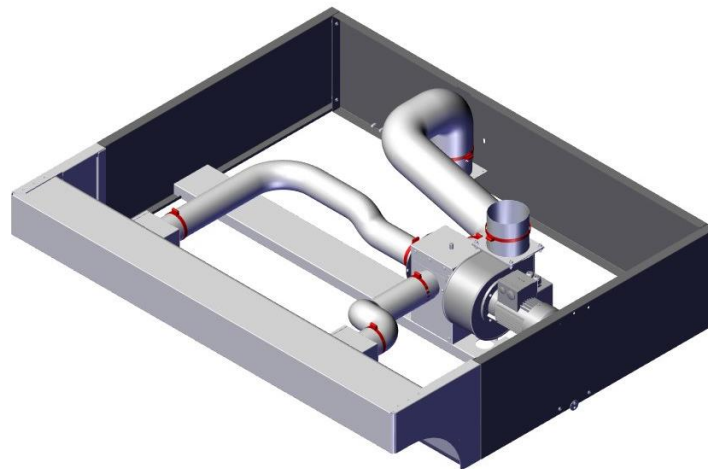
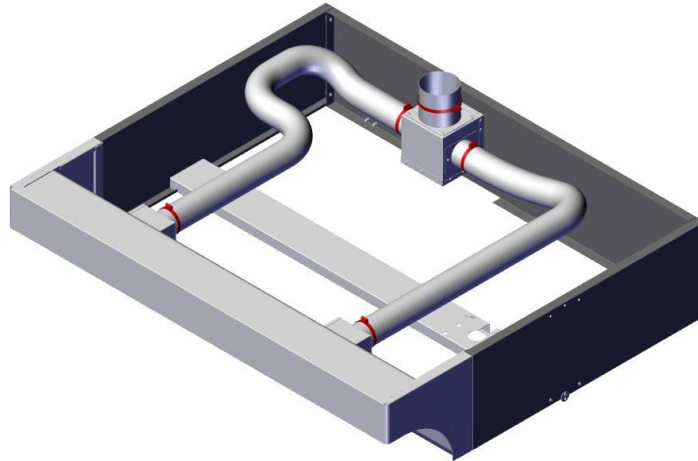

DRAUGHT CAP

NEUTRAL mod. 30/35/40

MOTORIZED mod. 30/35/40

Cod: OM40.00070



OEM ALI GROUP S.r.l a socio unico

Viale Lombardia, 33 Bozzolo (MN) - Italia
Tel. +39 0376 910511 – Fax +39 0376 920754

info@oemali.com – www.oemali.com

PREFACE

All rights reserved. No part of this publication can be reproduced, distributed, translated into other languages or transmitted by any electronic or mechanical means, including photocopy, recording or any other storage and retrieval system, for other purposes other than the only personal use of the buyer, without express written permission of the Manufacturer.

The Manufacturer is in no way responsible for the consequences of any mishandled operations carried out by the user.

EDITOR'S NOTE

This documentation is specifically intended for technicians; therefore, some information that is easily deductible from reading texts and examining drawings may not have been further specified.

The Publisher is not, in any way, responsible for the information and data in this manual: all the information contained therein has been provided, checked and approved during verification by the Manufacturer.

The Publisher is in no way responsible for the consequences of any mishandled operations carried out by the user.

GENERAL

All operational and maintenance instructions and recommendations described in this guide must be complied with. For best results, the Manufacturer recommends to perform regularly all the cleaning and maintenance operations to keep the plant in the best condition.

It's very important to train the personnel responsible for the machine, both in terms of its use, as well as for the maintenance and control of compliance with operating procedures and all the safety standards in this manual.

Edition: 06/2020

Version: 1.0

COPYRIGHT

© 2020 OEM ALI GROUP S.r.l. a socio unico

Summary

1	IDENTIFICATION.....	8
1.1	Manufacturer identification.....	8
1.2	Identification.....	8
1.3	Targa di identificazione.....	8
1.4	Declaration of Conformity CE (Fac-simile)	9
1.5	Reference Directives.....	10
2	PRELIMINARY INFORMATION.....	12
2.1	Recipients.....	12
2.2	Supply and Storage.....	12
2.3	Updates.....	12
2.4	Language.....	12
2.5	Operators.....	13
2.6	Symbols used in manual	14
2.7	Glossary	14
2.8	Individual protection devices	16
2.9	User safety areas	17
2.10	Warranty.....	18
3	SAFETIES	21
3.1	General Warnings.....	21
3.2	Safety devices.....	22
3.3	Noise.....	23
3.4	Vibrations.....	23
3.5	Electromagnetic compatibility	23
3.6	Remaining risk.....	24
4	DESCRIPTION.....	27
4.1	Correct use	27
4.2	Reasonably predictable wrong use.....	27
4.3	Obligations and prohibitions.....	28
4.3.1	User obligations	28
4.3.2	Staff obligation (operators/maintainers/technicians)	28
4.3.3	Staff prohibition (operators/maintainers/technicians)	28

4.4	Dati tecnici	Errore. Il segnalibro non è definito.
4.5	Layout measures	30
4.5.1	Cap measures - model 30 NEUTRAL	30
4.5.2	Cap measures - model 30 MOTORIZED	31
4.5.3	Cap measures - model 35/40 NEUTRAL	32
4.5.4	Cap measures - model 35/40 MOTORIZED	33
4.6	Main components	34
4.6.1	Neutral cap components	34
4.6.2	Motorized cap components	35
4.7	General description	36
4.7.1	Fumes passage in the neutral cap	36
4.7.2	Fumes passage in the motorized cap	37
5	TRASPORT AND INSTALLATION	39
5.1	Introduction	39
5.2	Packaging	39
5.2.1	Packaging removal	40
5.2.2	Packaging disposal	40
5.3	Transportation and handling	40
5.3.1	Group and Weight Division Table	41
5.3.2	Transport operations	41
5.4	Installation	43
5.4.1	Predisposition charced to the customer	43
5.4.2	Allowed environmental conditions	43
5.4.3	Cap positioning	45
5.4.4	Neutral/motorized cap assembly (model 30)	46
5.4.5	Neutral cap assembly (model 35/40)	47
5.4.6	Motorized cap assembly (model 35/40)	48
5.5	Connections	49
5.5.1	Electrical connection	49
6	CONTROLS AND USE	51
6.1	Operator positioning	51
6.2	Motorized cap control buttons	52
6.3	How to use it	53

6.3.1	Preliminary checks	53
6.3.2	Startup procedure	53
6.3.3	Turning off procedure	53
7	MAINTENANCE	55
7.1.	56	
7.1	Safety Warnings	56
7.2	Ordinary Maintenance	57
7.2.1	Cleaning	57
7.3	Extraordinary Maintenance	58
8	PUTTING THE EQUIPMENT OUT OF ORDER AND DISPOSING OF IT	61
8.1	Putting the equipment out of order and storing it	61
8.2	Disposal	62
9	ATTACHMENTS	65

PAGINA LASCIATA INTENZIONALMENTE BIANCA

Capitolo 1

IDENTIFICATION

1 IDENTIFICATION

1.1 Manufacturer identification

Manufacturer	OEM ALI GROUP S.r.l. a socio unico
Address	Viale Lombardia, 33 Bozzolo (MN) - Italia Tel. +39 0376 910511 – Fax +39 0376 920754 info@oemali.com - www.oemali.com

1.2 Identification

Type	NEUTRAL/MOTORIZED DRAUGHT CAP
Modello	MOD. 30/35/40
Year of construction	2020

1.3 Targa di identificazione

The machine has an identification plate located on the side panel.

On the plate there are the details of the machine to be mentioned in case of need to the OEM ALI GROUP S.r.l a socio unico.

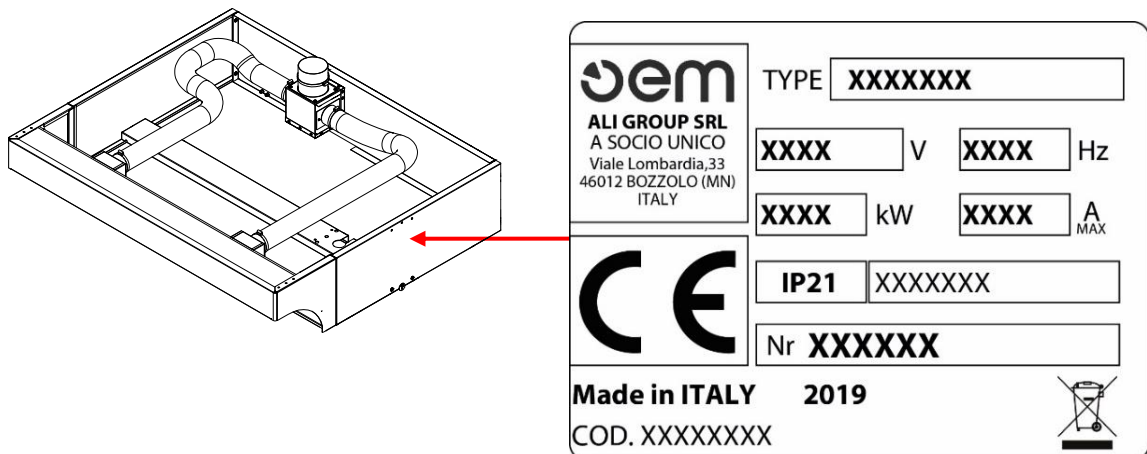

PROHIBITION!

It is absolutely forbidden to remove the CE identification plate and/or replace it with other plates. If, for accidental reasons, the license plate is damaged or removed, the customer must inform the Manufacturer.

1.4 Declaration of Conformity CE (Fac-simile)

 OEM YOUR PIZZA HUB	DICHIARAZIONE DI CONFORMITÀ CE	Direttiva 2006/42/CE Direttiva 2014/53/UE Direttiva 2011/65/UE
	Macchina, modello e tipo: CAPPA ASPIRAZIONE	Pagina 1 di 1

CE

DICHIARAZIONE DI CONFORMITÀ CE

Ragione sociale del fabbricante o nel caso del suo mandatario:	OEM ALI GROUP S.r.l. a socio unico
Indirizzo:	Viale Lombardia, 33 46012 – Bozzolo (MN) – Italy Tel. +39 0376 810511 - Fax +39 0376 820754 e-mail: info@oemali.com sito web: www.oemali.com
Descrizione e identificazione della macchina	CAPPA ASPIRAZIONE NEUTRA MOTORIZZATA serie 30/35/40
Anno	2020
Persona autorizzata a costituire il fascicolo tecnico	Giacomo Bonfiglioli Viale Lombardia, 33 46012 – Bozzolo (MN) – Italy

IL PRODOTTO È CONFORME AI REQUISITI ESSENZIALI DELLE DIRETTIVE EUROPEE:

- **MACCHINE (MD): 2006/42/CE**
- **COMPATIBILITÀ ELETTRICITÀ (EMC): 2014/30/UE**
- **BASSA TENSIONE: 2014/36 UE**
- **RoHS II: 2011/65/UE ed s.m.i. del Parlamento Europeo**
- **Direttiva sui rifiuti di apparecchiature elettriche ed elettroniche (RAEE): 2012/19 CE :**

Sono state inoltre applicate le seguenti norme:
 EN 55014-1:2008
 EN 55014-2:1997 + A1:2001 + A2:2008
 EN 61000-3-2:2008
 EN 61000-3-3:1995 + A1:2001 + A1:2001 + A2/151:2005
 EN 61000-3-11:2000
 EN 61000-3-12:2005
 EN 62233:2008
 EN 60335-2-36:2000 + A1:2004 + A2:2008 (EN 60335-1:2002+A1:2004+A11:2004+A12:2006+A2:2006)

Luogo e data emissione:	Bozzolo (MN), __/__/__
Nome: Bonfiglioli Giacomo	
Funzione: Legale rappresentante	
	Firma: _____

1.5 Reference Directives

The machine supplied by OEM ALI GROUP S.R.L A SOCIO UNICO does not belong to one of the categories of machines listed in the list covered in Annex IV of the Directive; therefore, for the purpose of the declaration of conformity of the machine to the present directive, OEM ALI GROUP S.R.L A SOCIO UNICO applies the procedure of compliance assessing with internal control on the manufacture of the machine, see attached VIII.

In order to certify the machine's compliance with the provisions of the Directive, OEM ALI GROUP S.R.L A SOCIO UNICO before to entry in the market, carried out the risk assessment in order to verify compliance with the essential safety and health requirements provided by the Directive as well as the tests and checks provided by the relevant reference rules. The technical construction file was produced in accordance with Annex VII of the 2006/42/CE Directive and it is available to be verified by supervisory bodies on a reasoned application, as required by the relevant legislation.

OEM ALI GROUP S.R.L A SOCIO UNICO provides the introduction on the market of the machine by equipping it and accompanying it with:

CE Marking	
CE Declaration of Conformity	
Instruction and Warning Manual	(Documentation drawn up in paragraph 1.7.4 of the Machines Directive 2006/42/CE)

Please note that the oven was designed according to the following Guidelines:

2006/42/CE	Machines Directive
2014/30/UE	Electromagnetic Compatibility Directive

Chapter 2

PRELIMINARY INFORMATION

2 PRELIMINARY INFORMATION

2.1 Recipients

The manual is intended for operators in charge of using and managing the machine in all its stages of technical life. It contains themes that refer to the correct use of the machine, in order to maintain the functional and qualitative characteristics of the machine over time.

All information and warnings are for a proper use in complete safety.

The manual, like the CE Declaration of Conformity, is an integral part of the machine and must always accompany it in every move or resale.

It is the user's job to keep this documentation intact, to allow it to be consulted, throughout the life of the machine.

2.2 Supply and Storage

The manual is provided in **paper and electronic** format. All additional documentation will be provided in the annex to this manual. This manual can be downloaded in pdf format by linking to the site: www.oemali.com.

Keep this manual in conjunction with the machine, so that it can be easily consulted by the operator.

The manual is an integral part of the safety, so:

1. **must be kept intact** (in all its parts). If it is lost or ruined, you should immediately request a copy.
2. **must follow the machine until demolition** (even in the case of movements, sale, rental, rent, etc...);
3. **The attached manuals are part of this documentation** and apply to them the same recommendations/prescription as this manual.

The **Manufacturer** declines all responsibility for the wrong use of the machine and/or for damages caused as a result of operations not covered in the technical documentation.

2.3 Updates

If the machine needs functional modifications or replacements, the Manufacturer is responsible for reviewing or updating the manual. The Manufacturer is responsible for delivering the manual update.

The user is also responsible for ensuring that, if this document is modified by the Manufacturer, the updated versions of the manual are actually present at the points of use.

2.4 Language

The original manual was written in **Italian**.

Any translations in additional languages must be done from the original instructions.

The Constructor is responsible for the information contained in the original instructions; translations in different languages cannot be fully verified, so if an inconsistency is detected you must follow the text in the original language or contact our Technical Documentation Office.

2.5 Operators



In order to establish with certainty what are the skills and qualifications of the operators involved in the various tasks (starting, cleaning, routine maintenance), see the following table:

Qualification	DEFINITION
Operator	<p>Part of the User's staff trained and machine-enabled for production purposes for the activities for which it was built and supplied.</p> <p>He will be able to perform all the necessary operations for the proper functioning of the machine and for the safety of himself or any collaborators. he must have a proven experience of using these types of machines and be trained, informed and educated about them.</p> <p>In case of doubt, he should report any anomaly to his superior.</p> <p>Note: he isn't authorized to perform any maintenance activity.</p>
Mechanical Maintainer	<p>Qualified technician able to perform preventive/corrective maintenance on all mechanical parts of the machine subject to maintenance or repair.</p> <p>Qualified technician able to have access to all parts of the machine for visual analysis, equipment health control, adjustments and calibrations.</p> <p>Qualified technician capable of:</p> <ol style="list-style-type: none"> 1. using the machine as the operator; 2. intervening on mechanical organs for adjustments, maintenance and repairs; 3. reading technical drawings and spare part-list. <p>In extraordinary cases, he is trained to work the machine with reduced safeties.</p> <p>If necessary, it can give instructions to the operator for a good use of the machine for production purposes.</p> <p>Note: he is not enabled to intervene on electrical systems under tension.</p>
Electric Maintainer	<p>Qualified technician able to carry out preventive/corrective maintenance on all electrical parts of the machine subject to maintenance or repair.</p> <p>Qualified technician able to have access to all parts of the machine for visual analysis, equipment health control, adjustments and calibrations.</p> <p>Qualified technician capable of:</p> <ol style="list-style-type: none"> 1. using the machine as the operator; 1. intervening on adjustments and electrical systems for maintenance, repair and replacement of worn parts; 1. reading electrical diagrams and check the correct functional cycle. <p>If necessary, it can give the operator instructions for a good use of the machine for production purposes.</p> <p>He can operate in the presence of voltage inside the electrical panels, derivation boxes, control equipment etc. only if he is the appropriate person (PEI). (Reference regulatory EN50110-1).</p>
Manufacturer's Technician	<p>Technician qualified by the Manufacturer and/or by his distributor for complex operations, because he knows the production cycle of construction of the machine.</p> <p>This person intervenes in accordance with the user's requests.</p> <p>Skills are mechanical.</p>

The qualifications shown in the table on this page are obligatory within a category of people defined as "trained person".

TYPE	DEFINITION
Trained Person	The one who has been informed, instructed and trained at work and any dangers arising from misuse. He also knows the importance of safety devices, safety standards and safe working conditions.

2.6 Symbols used in manual

SYMBOL	DEFINITION
	Symbol used to identify warnings that are important for the safety of the operator and/or machine.
	Symbol used to identify information of particular importance in the manual. The information also relates to the safety of personnel involved in the use of the machine.
	Symbol used to indicate a general prohibition.

2.7 Glossary

In manuals you can find a technical terminology or with an unusual meaning.

The following explains the used terms and abbreviations:

TERM	DEFINITION
Lifting accessories	Components or equipment not connected to the machines that allow, located between the machine and the load or on the load itself, the grasp of the load. The harnesses and their components are also considered lifting accessories.
ATEX	It derives from the words AT mosphères and EX plosibles and it is the conventional name that groups two directives of the European Union (EU): <ul style="list-style-type: none"> • 2014/34/EU for the regulation of the equipment used in explosion risk areas; • 99/92/CE for the safety and health of the workers in explosive atmospheres or in explosion risk environments.
Failure	A general failure that prevents the normal operation of a machine, a plant, etc.
Chains, ropes or straps	Elements designed and built for lifting purposes as an integral part of lifting machines or lifting accessories.
Damage	Any adverse consequences resulting from the occurrence of a dangerous event.
D.P.I.	The term Individual Protection Device (acronym DPI) refers to products that have the function of safeguarding the worker (operator, maintainer, technician, etc.) that you wear or take them with you, from health and safety risks.
breakdown	Element totally deprived of normal ability to execute a required function.

TERM	DEFINITION
Support	Equipped or intended to be equipped with an activation system, composed of parts or components, at least one of which moves, connected to each other solidly for a well-established application.
Malfunction	Faulty or inappropriate operation of a machine or one of its elements performing a particular function.
Protection measure	Expected measure to achieve risk reduction, implemented: <ul style="list-style-type: none"> • By the designer (inherently safe design, additional protections and protection measures, information for use) and/or • By the user (organization: safe working procedures, surveillance, work permits; provision and use of additional means of protection; use of personal protective equipment; training).
Danger	Potential source of damage that, if not avoided, implicates a risk to the safety and health of the people exposed.
Exposed person	Any person who is entirely or in part in a dangerous area.
Prevention	The set of necessary provisions or measures, also according to the particularity of the work, experience and technique, to avoid risks or reduce the chances of happening.
Protection	Defense against what could harm. An element that is between those who can suffer the damage and what can cause it for hazards that cannot be reasonably eliminated or for risks that cannot be sufficiently reduced during design. We distinguish: <ul style="list-style-type: none"> • active protection that the operators themselves must activate (emergency stops for example) and/or wear (DPI); • passive protection that intervenes even without human command.
Barrier	Physical barrier, designed as part of the machine, to provide protection.
Fixed Barrier	Protection held in place (i.e. closed) or permanently (welded) or by means of fastening systems (screws, bolts, etc.) that make it impossible to remove/open without the help of tools (keys, screwdrivers or hex key). Easy-to-remove fasteners are not allowed (e.g. plastic knob).
Mobile Barrier	Barrier mechanically connected to the machine structure (e.g. with hinges or guides) that can be opened without the use of tools.
Risk	Combination of the probabilities of damage and the severity of that damage.
Residual risk	Risk that remains after taking protection and prevention measures.
Transpallet	A mechanical vehicle used to handle loads in warehouses, industrial interiors or external yard. The vehicle moves on rubberized or non-rubber wheels, either by electric or manual traction and it is equipped with a pneumatic lift system that allows to detach the load from the ground and to move it.
Expected use	Use of a machine in accordance with the information provided in the instructions for use.
Reasonably predictable misuse	Use of a machine in a way not foreseen by the designer, but that can result from an easily predictable human behavior.

2.8 Individual protection devices

When you work near the machine, both for assembly operations, and for maintenance and/or regulation operations, you must strictly comply with the general anti-injury rules, for this it will be important to use the individual protection devices (D.P.I.) required for each operation.

Here is the full list of **individual protection devices (D.P.I.)** that can be requested for different procedures:

SYMBOL	DESCRIPTION
	Obligation to use protective or insulation gloves. It indicates a requirement for staff to use protective or insulation gloves.
	Obligation to use safety shoes. It indicates a prescription for staff to use safety shoes to protect their feet.
	Obligation to wear protective clothing. It indicates a requirement for staff to wear specific protective clothing.
	Obligation to use protective helmet. It indicates a requirement for staff to use a helmet to protect their head.
	Obligation to use protective glasses. Indicates a prescription for staff to use protective glasses.
	Obligation to use noise protection devices. It indicates a prescription for staff to use headphones or earplugs to protect their hearing.
	Obligation to read the manual of instructions. It indicates a requirement for staff to consult (and understand) the support instructions and warning before working with it

The clothing of those who operate or maintain the machine must comply with the essential safety requirements defined by the EU 2016/425 and the laws in the country where the machine is installed.

2.9 User safety areas

The areas around the machine are divided as follows:

TERM	DESCRIPTION
Command areas	These are the areas where the user and other operators can perform control and command operations of the cyclical functions of the machine both automatically and semi-automatically, acting on the appropriate control panels or for the execution of the manual operations.
Maintenance Zones/ Adjustment	These are the areas where mechanical maintainers can perform maintenance or regulation. These areas are considered dangerous and not accessible during the normal operation of the oven. Operators should be fully aware of safety warnings and individual devices to wear.
Dangerous areas	All spaces inside and/or around the machine where a person may be exposed to danger.

The dangers and risks that exist in these areas are protected, as far as possible, by **protections** (carters, hatches).



BAN!

When the machine is ON, it is ABSOLUTELY BANNED to operate in dangerous areas as some risks may not have been totally cancelled.

2.10 Warranty

The full warranty clauses are listed in the sales agreement.

The terms of the trade agreement (if different) take precedence over what is in this section.

The warranty is **subject** to the following general conditions:

- **opening of the packaging and installation** must be carried out in the presence of the technicians authorized by the Manufacturer;
- The **first start and positive testing** of the installed machine must be done in the presence and under the guidance of the Manufacturer's technicians; the intervention sheet related to the installation/testing of the oven must be completed.
- The machine must be used **within the limits declared** in the contract and reported in the technical documentation.
- **Maintenance** must be carried out in the time and manner provided by the manual, using original spare parts OEM ALI GROUP S.R.L A SOCIO UNICO and entrusting the interventions to qualified personnel.

The warranty **expires** if:

- failure to respect **safety standards**;
- **removal or tampering** of the control and security devices (protections);
- **changes to the safety conditions established by the Manufacturer** in the machine management software;
- **misuse** of the machine;
- use of the machine by **uneducated and/or unauthorised personnel** or non-compliance with the competences of the various operators, as indicated in the manual;
- **modifications or repairs** made by the user without the Builder's written permission;
- **partial or total non-compliance** of instructions;
- **power defects** (electric, compressed air, etc.);
- **lack of maintenance**;
- use of **non-original** parts;
- **exceptional events** such as flooding, fires (if not caused by machines).



Additional details may be present in the trade agreement.

The terms of the trade agreement (if different) take precedence over what is in this section.

PAGINA LASCIATA INTENZIONALMENTE BIANCA

Chapter 3

SAFETIES

3 SAFETIES

3.1 General Warnings

The **user** (entrepreneur or employer) must:

- carefully read this manual and gain a deep understanding of the technical specifications and controls before putting into operation the machine;
- train the operator on the use of the machine;
- check that the installation area of the device is compatible with the size and weight of the machine;
- Use lifting equipment appropriate to the weight and characteristics of the piece to be lifted/moved;
- Prevent the use of the machine to unauthorized personnel;
- Prevent the removal of panels that protect mechanical and electrical parts during the operation of the machine;
- ensure that the buyer's power system is equipped with an automatic release system upstream of the general machine switch and a suitable grounding system that meets accident prevention rules;
- remove tension from the line where the general switch is fastened in case of interventions;
- Maintenance protection removal operations must be carried out **ONLY** by specialized and authorized personnel;
- Ensure that safety devices (barriers, protections, carters, micro-switches, etc.) have not been tampered with and that they are fully functional. If not, arrange them;
- Avoid removing security devices;
- use only suitable equipment that complies with safety regulations;
- Avoid tampering with the electrical system, tire or other mechanisms;
- Do not leave the device unattended;
- Wear clothing that complies with safety regulations;
- Use ladders or lifting equipment that comply with safety standards in case of interventions on positions not directly reachable from the ground;
- ensure that there are no organs that can come into operation and/or details placed on the machine in case of maintenance;
- use appropriate DPI and tools;
- Do not remove warning tags;
- Prevent maintenance when the machine is ON;
- **ONLY** to authorized personnel can perform maintenance operations;
- Prevent children from playing or performing cleaning and/or maintenance on the machine;
- use the machine **ONLY** as described in the paragraph "CORRECT USE";
- avoid making hasty or successful repairs that could compromise the smooth running of the machine and the safety of the operator.



ATTENTION!

Before cleaning and/or maintaining, make sure that the general switch on "0" - "OFF" to remove the power supply.



ATTENTION!

The removal of the plug must be such that an operator can verify from anywhere that the plug is disconnected.



IMPORTANT!

Misuse of the machine excludes any responsibility of the Manufacturer.

3.2 Safety devices

The machine has safety devices described in the following table. For the location of these devices, refer to the drawing below the table.

POS.	TERM	DESCRIPTION
1	Fixed protections	<p>Fixed protections consist of fixed perimeter barriers, which are responsible for preventing access into the machine and its units through areas other than the main openings.</p> <p>The machine has fixed protections, placed in areas with exclusive access during maintenance and requiring specific tools for their removal.</p>

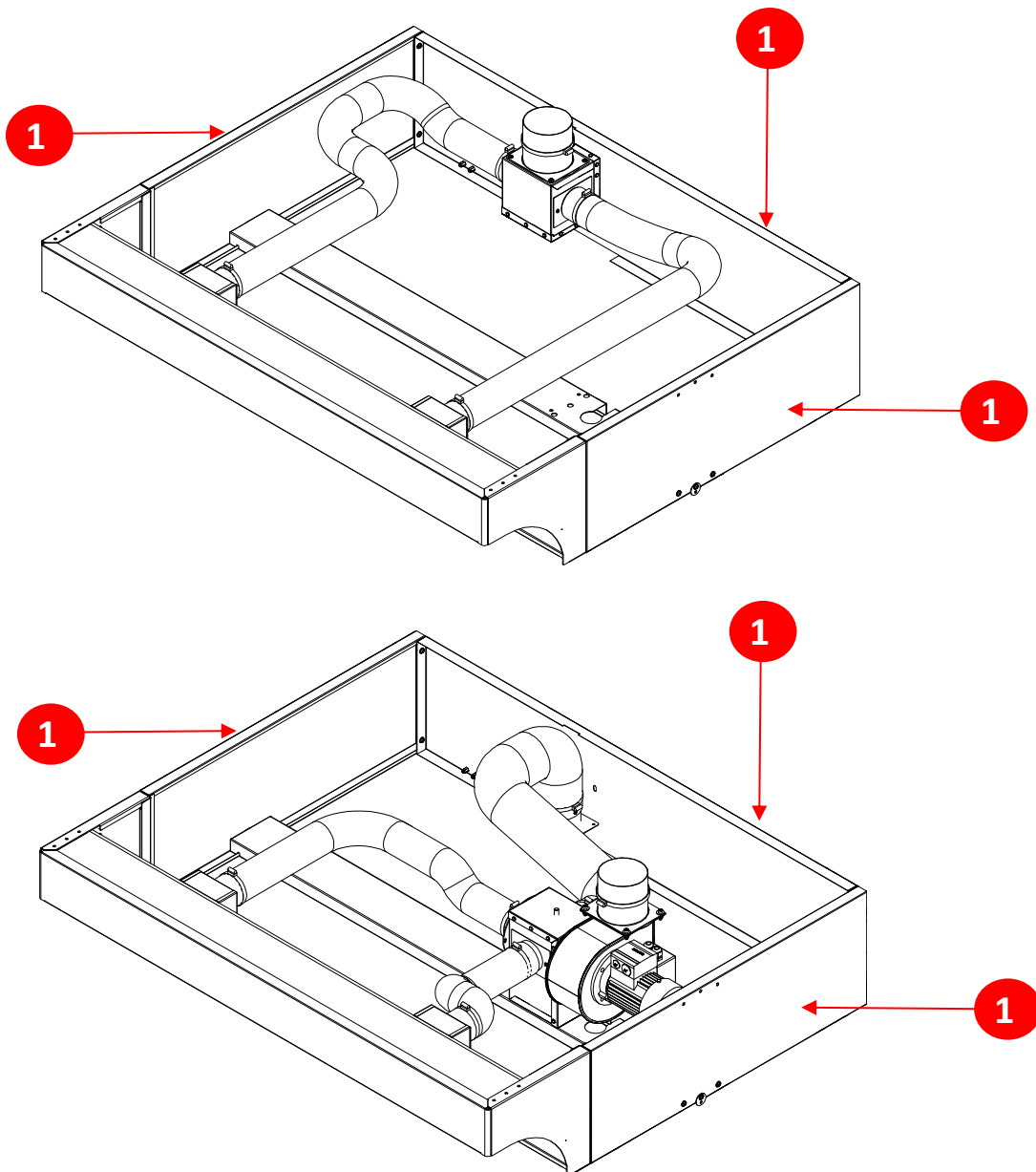

3.3 Noise

Noise measurements were made in accordance with **UNI EN 11200** and **UNI EN ISO 3746** standards.

During operating cycles, **the staff noise exposure** is less than **80 dB**.

The actual noise level of the machine installed during operation at the site in a production process is different from that detected because the noise is affected by certain factors such as:

- type and site features;
- other adjacent machines in operation.

It is the user's responsibility to apply the preventive and protective measures that follow, in accordance with the legislation of the country of installation and use of the machine.

3.4 Vibrations

The vibrations produced by the machine **are not dangerous** to the health of the operators.



ATTENTION!

Excessive vibration can only be caused by a mechanical failure that must be immediately reported and eliminated, not to affect the safety of the machine and operators.

3.5 Electromagnetic compatibility

The machine contains electronic components subject to Electromagnetic Compatibility regulations, conditioned by piped and irradiated emissions.

Emissions values are part of the regulatory requirements thanks to the use of components that comply with the Electromagnetic Compatibility Directive, suitable links and the installation of filters where necessary.

The machine is therefore compliant with the Electromagnetic Compatibility Directive (EMC).



ATTENTION!

Maintaining electrical equipment activities that are performed non-compliantly or mis-replaced components can compromise the efficiency of the used solutions.

3.6 Remaining risk

The machine was designed to ensure the essential safety requirements for the operator.

Safety, as far as possible, has been integrated into the design and construction of the machine; however, there are still risks from which operators need to be protected especially during:

- transport and installation;
- normal operation;
- adjustment and set-up,
- maintenance and cleaning;
- dismantling.

Below, for each residual risk is provided a description, the area or part of the machine subject to the risk and the procedural information on how to avoid it:

RISK	DESCRIPTION AND PROCEDURAL INFORMATION
Electrical danger	Contact of people with elements under tension. Cleaning/maintenance always with the machine off Only the PES/PAV electric maintainer with the suitability for work under voltage under CEI 11-27, can perform extraordinary maintenance with suitable DPI.
Thermal danger	Contact of people with elements that can cause burns, caused by contact with objects or materials with an extreme temperature.
Dangers generated by materials and substances processed, used, produced or discharged from the machine	Danger of fire or explosion (due to materials, powders, liquids, substances and gases, used or produced).
Dangers generated by materials and substances processed, used, produced or discharged from the machine	Biological (mold) and microbiological dangers (viruses or bacteria).



ATTENTION!

Do not carry out maintenance and cleaning tasks **if you have not** de-energized the energies.

It will be user care to:

- analyse the risks that may occur during a handling and installation phase inside your location (The analyses carried out on the handling of the machine were made only in consideration of the its characteristics);
- delimit the path of forklift and/or laser vehicles driven with signs on the floor;
- raise awareness and educate the operations staff on workstations and who conducts the machine.
- apply visual safety signs in the work environment after assessing risks inside transit or control areas.

PAGINA LASCIATA INTENZIONALMENTE BIANCA

Chapter 4

DESCRIPTION

4 DESCRIPTION

4.1 Correct use

The machine in question is intended to be used for:

OPERATION	ALLOWED	PROCESSING ENVIRONMENT
fumes extraction	Pizza oven fumes	Locale di ristorazione

The machine was created to:

- meet the specific requirements mentioned in the sales agreement;
- be used following instructions and limits of use in this manual.

The machine is designed and built to work safely if:

- it is used within the limits declared on the contract and this manual;
- the procedures of the user manual are followed;
- routine maintenance is carried out in the specified time and manner;
- extraordinary maintenance is carried out in a timely manner in case of need;
- security devices are not removed and/or bypassed.

4.2 Reasonably predictable wrong use

Reasonably **predictable wrong use**, is listed below:

- to use the machine as a foothold for unsuitable components;
- to use the machine to obtain production values over the prescribed limits;
- to use the machine differently than provided in section "**Correct use**".

Any other use of the machine than expected must be authorized in writing by the Manufacturer. In the absence of such written authorization, the use is to be considered "**improper use**"; therefore, the Manufacturer disclaims any liability in relation to any damage caused to property or persons and considers any kind of guarantee on the oven to be expired.



IMPORTANT!

Misuse of the machine excludes any responsibility of the Manufacturer.

4.3 Obligations and prohibitions

4.3.1 User obligations

The **user** (entrepreneur or employer) must:

- consider the abilities and conditions of the operators in relation to their health and safety;
- provide the appropriate means of individual protection conform to each procedure;
- Provide standard lifting means and procedures;
- Require individual workers to comply with company rules and regulations on safety and the use of collective and individual protections;
- educate staff on accident procedures;
- educate staff about residual risks;
- educate staff on operator safety devices;
- educate staff on the general safety rules provided by European directives and the legislation of the country where oven is targeted.

Only personnel who have seen this manual and properly trained can operate on the machine.

4.3.2 Staff obligation (operators/maintainers/technicians)

The Staff **has to**:

- Perform maintenance always with the machine off.
- Perform interventions on all components of the electrical system always with the general switch off.
- When you start the machine, make sure that there is no foreign object inside.
- appropriately use the protective equipment provided by the employer.
- Report safety device deficiencies to your employer, manager, or supervisor immediately.

4.3.3 Staff prohibition (operators/maintainers/technicians)

In particular, the staff **mustn't**:

- use the machine improperly, that is, for uses other than those indicated in the paragraph "**Correct Use**";
- remove or modify security or signaling devices without permission;
- carry out operations on their own initiative or that may compromise the safety of their own or other workers;
- change the operation of the machine;
- modify electrical connections to exclude internal security;
- use the oven if not installed according to the applicable regulations;
- use the oven outside of the allowed environmental conditions (see "**chapter 5**").

ATTENTION!

OEM ALI GROUP S.R.L A SOCIO UNICO does not respond for damages caused by things or people when:



- **the machine** has been used in one of the spaces that are **not allowed**;
- **described obligations and prohibitions have not been met.**

4.4 Technical data

MOTORIZED CAP POWER SUPPLY DATA	
Voltage	400V (1~+ PE)
Frequency	50 Hz
Absorption	1,9 A
Average consumption	-
Power	0,25 kW

4.5 Layout measures

4.5.1 Cap measures - model 30 NEUTRAL

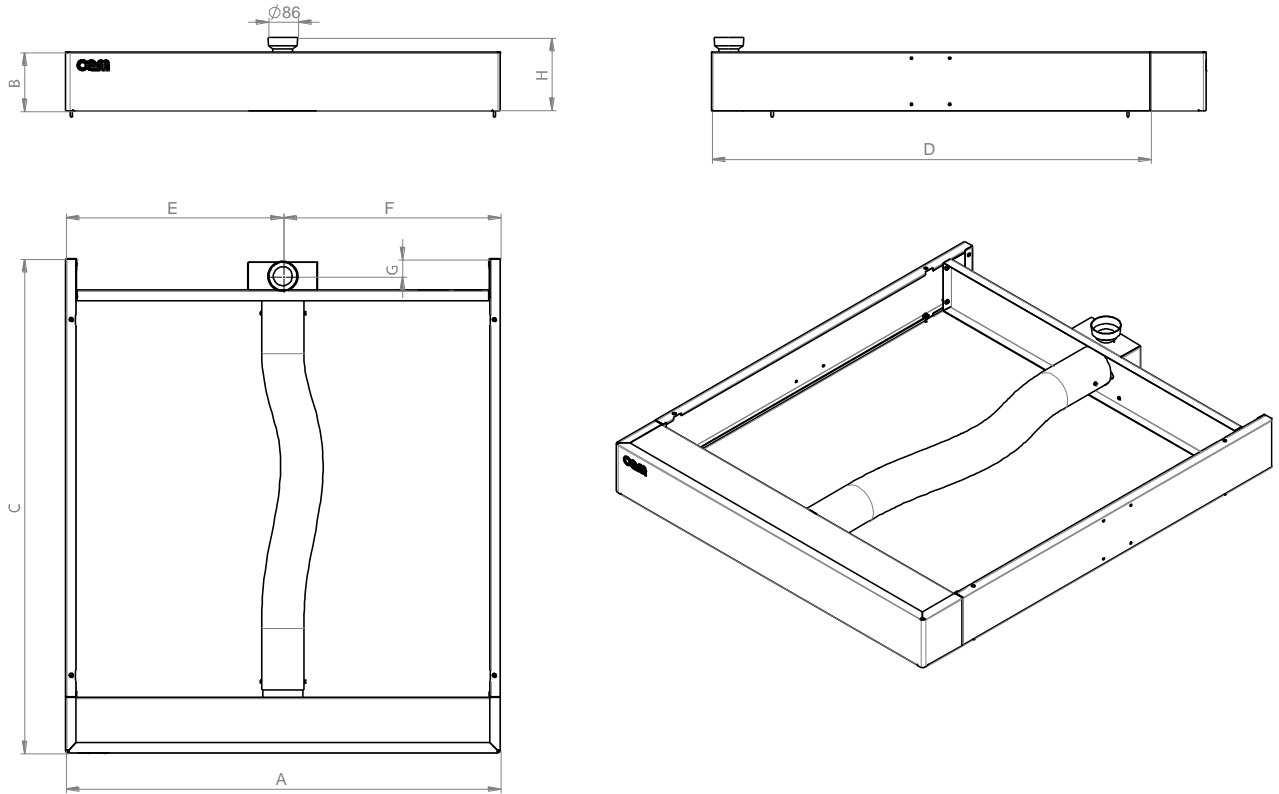

MODELLO	TIPO	A	B	C	D	E	F	G	H
430	NEUTRAL	882	170	933	771	441	441	50	212
630L	NEUTRAL	1196	170	933	771	598	598	50	212
630S	NEUTRAL	882	170	1233	1071	441	441	50	212
930	NEUTRAL	1196	170	1233	1071	598	598	50	212

4.5.2 Cap measures - model 30 MOTORIZED

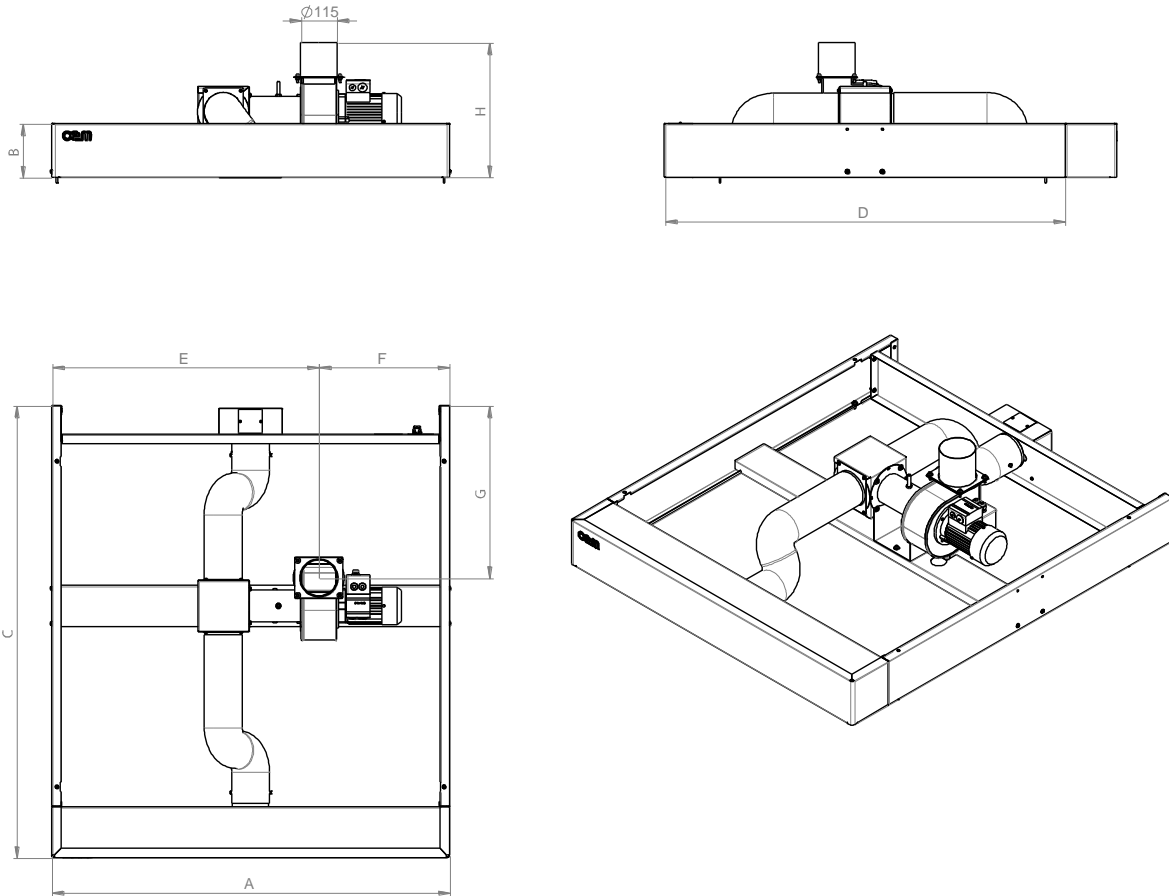

MODELLO	TIPO	A	B	C	D	E	F	G	H
430	MOTORIZED	882	170	933	771	573	309	367	434
630L	MOTORIZED	1196	170	933	771	887	309	367	434
630S	MOTORIZED	882	170	1233	1071	573	309	448	434
930	MOTORIZED	1196	170	1233	1071	887	309	448	434

4.5.3 Cap measures - model 35/40 NEUTRAL

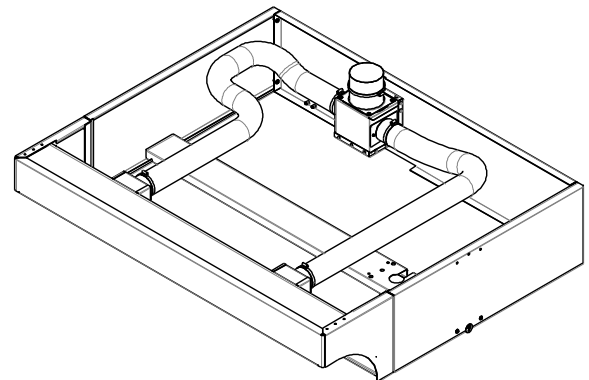
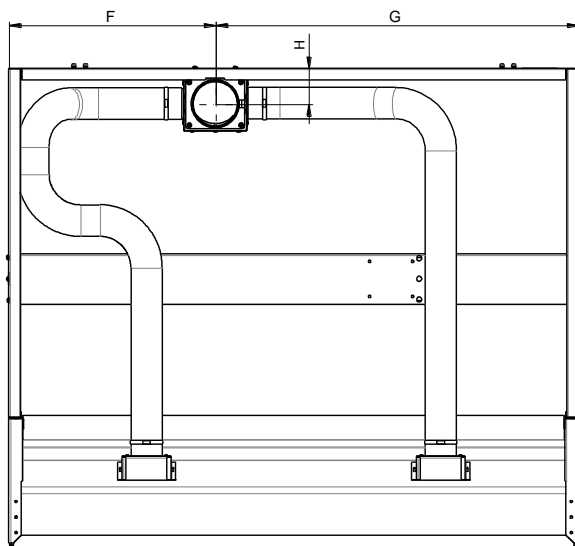
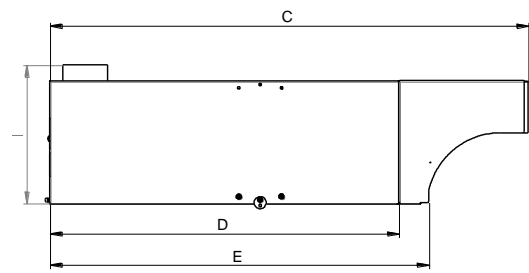
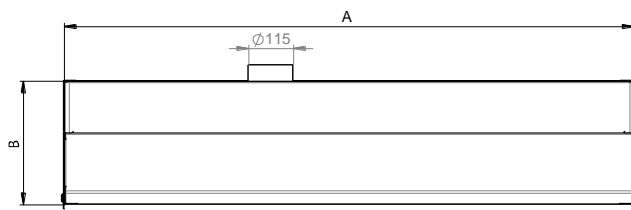

MODELLO	TIPO	A	B	C	D	E	F	G	H	I
435	NEUTRAL	1083	316	1226	895	971	340	743	91	356
635L	NEUTRAL	1460	316	1226	895	971	529	931	91	356
635S	NEUTRAL	1083	316	1576	1245	1321	340	743	91	356
935	NEUTRAL	1460	316	1576	1245	1321	529	931	91	356
440	NEUTRAL	1168	316	1326	995	1071	383	785	91	356
640L	NEUTRAL	1588	316	1326	995	1071	593	995	91	356
640S	NEUTRAL	1168	316	1746	1415	1491	383	785	91	356
940	NEUTRAL	1588	316	1746	1415	1491	593	995	91	356

4.5.4 Cap measures - model 35/40 MOTORIZED

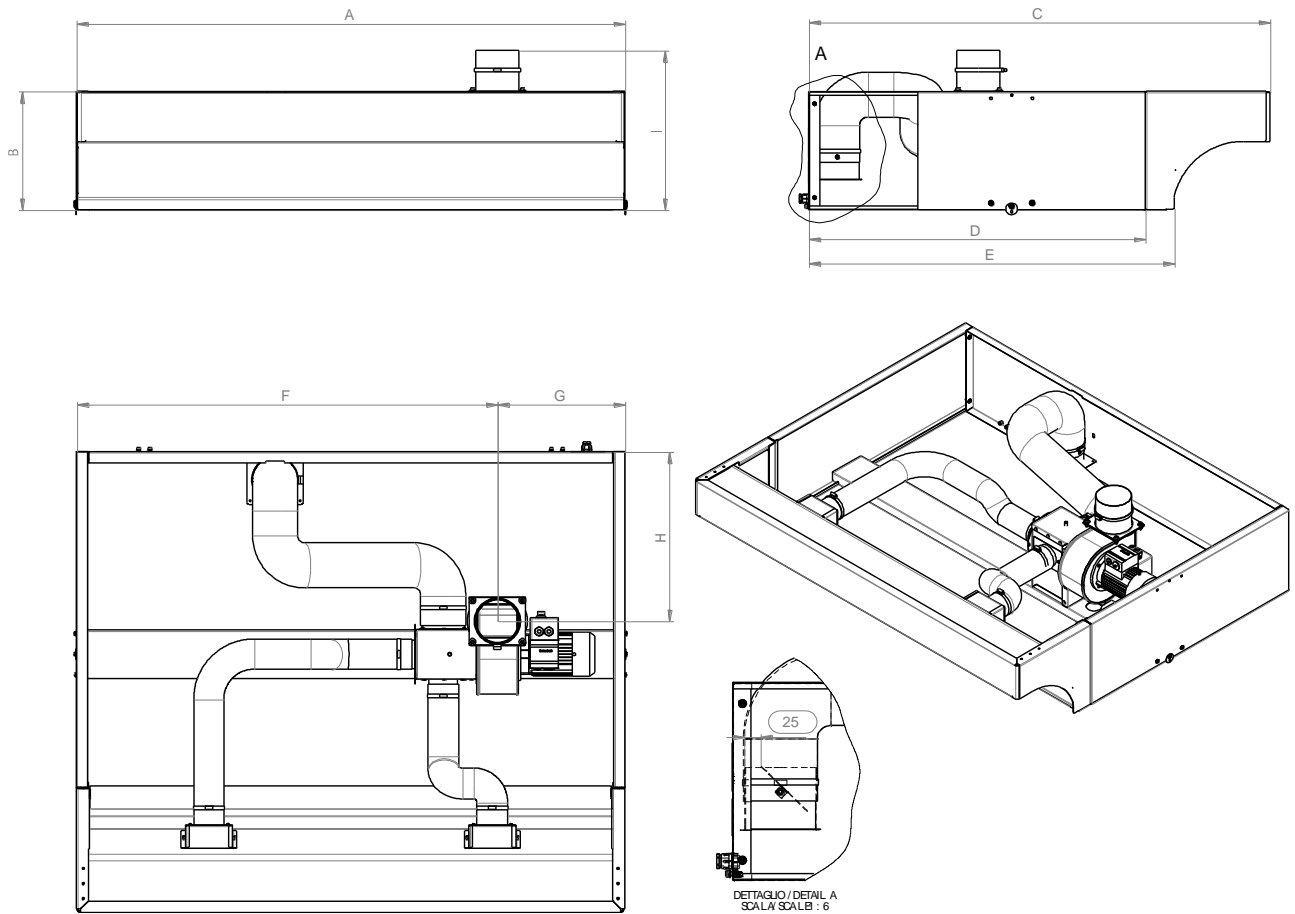

MODELLO	TIPO	A	B	C	D	E	F	G	H	I
435	MOTORIZED	1083	316	1226	895	971	744	339	452	425
635L	MOTORIZED	1460	316	1226	895	971	1120	339	452	425
635S	MOTORIZED	1083	316	1576	1245	1321	744	339	527	425
935	MOTORIZED	1460	316	1576	1245	1321	1120	339	527	425
440	MOTORIZED	1168	316	1326	995	1071	829	339	552	425
640L	MOTORIZED	1588	316	1326	995	1071	1249	339	552	425
640S	MOTORIZED	1168	316	1746	1415	1491	829	339	697	425
940	MOTORIZED	1588	316	1746	1415	1491	1249	339	697	425

4.6 Main components

4.6.1 Neutral cap components

The hood consists of the following fundamental parts:

POS.	DESCRIZIONE
1	Side panels
2	Hood frontal suction
3	conveyor
4	Fume suction pipes

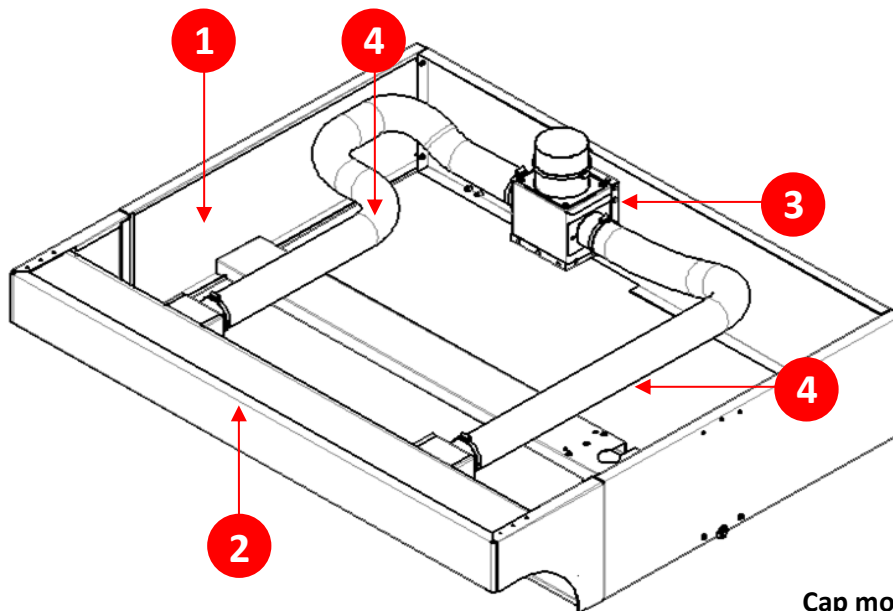

Cap model 35/40

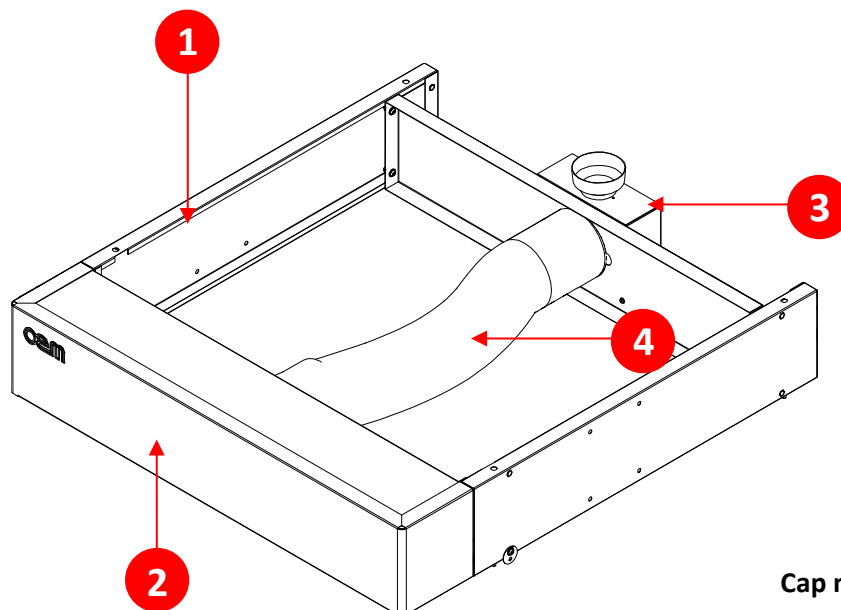

Cap model 30

4.6.2 Motorized cap components

The hood consists of the following fundamental parts:

POS.	DESCRIZIONE
1	Side panels
2	Hood frontal suction
3	Engine
4	Fume suction pipes
5	Control panel
6	Valve

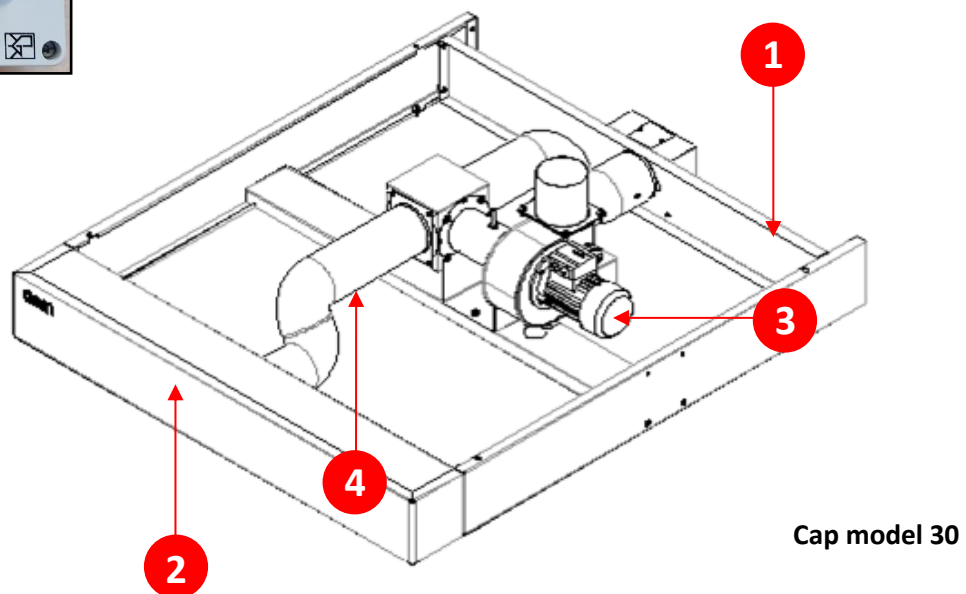
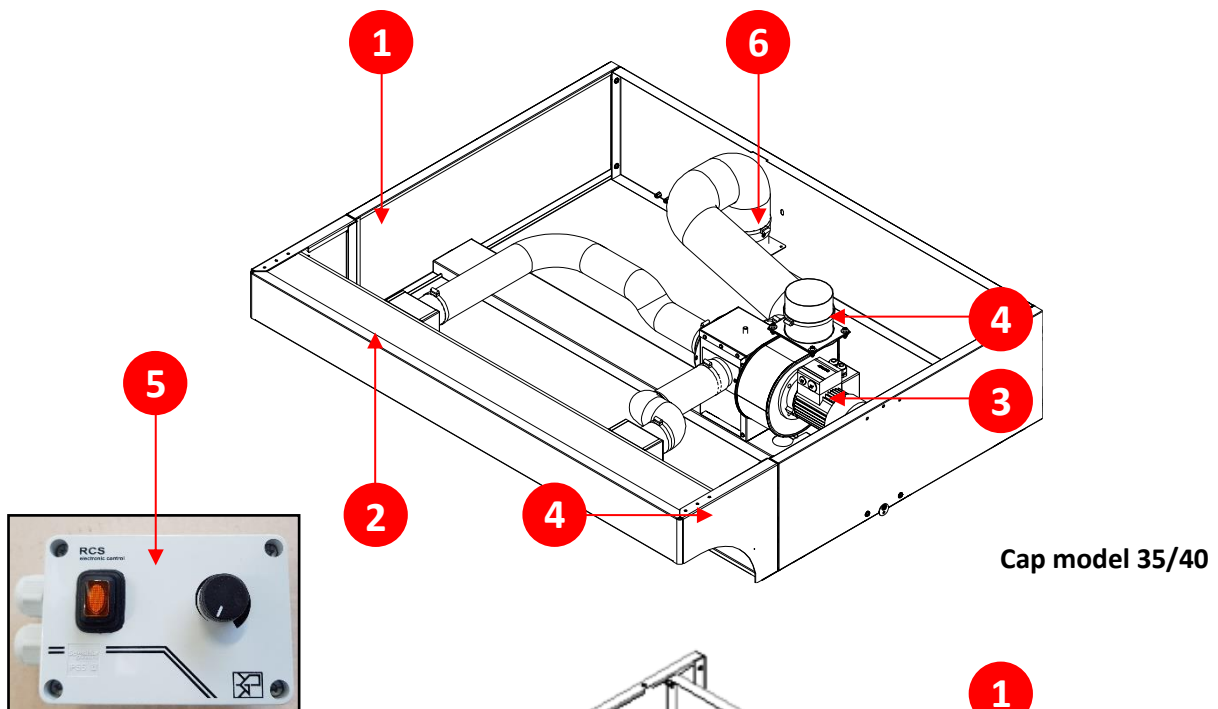

4.7 General description

The machine is designed to suck fumes from the oven.

4.7.1 Fumes passage in the neutral cap

Below is the passage of the fumes inside the cap:

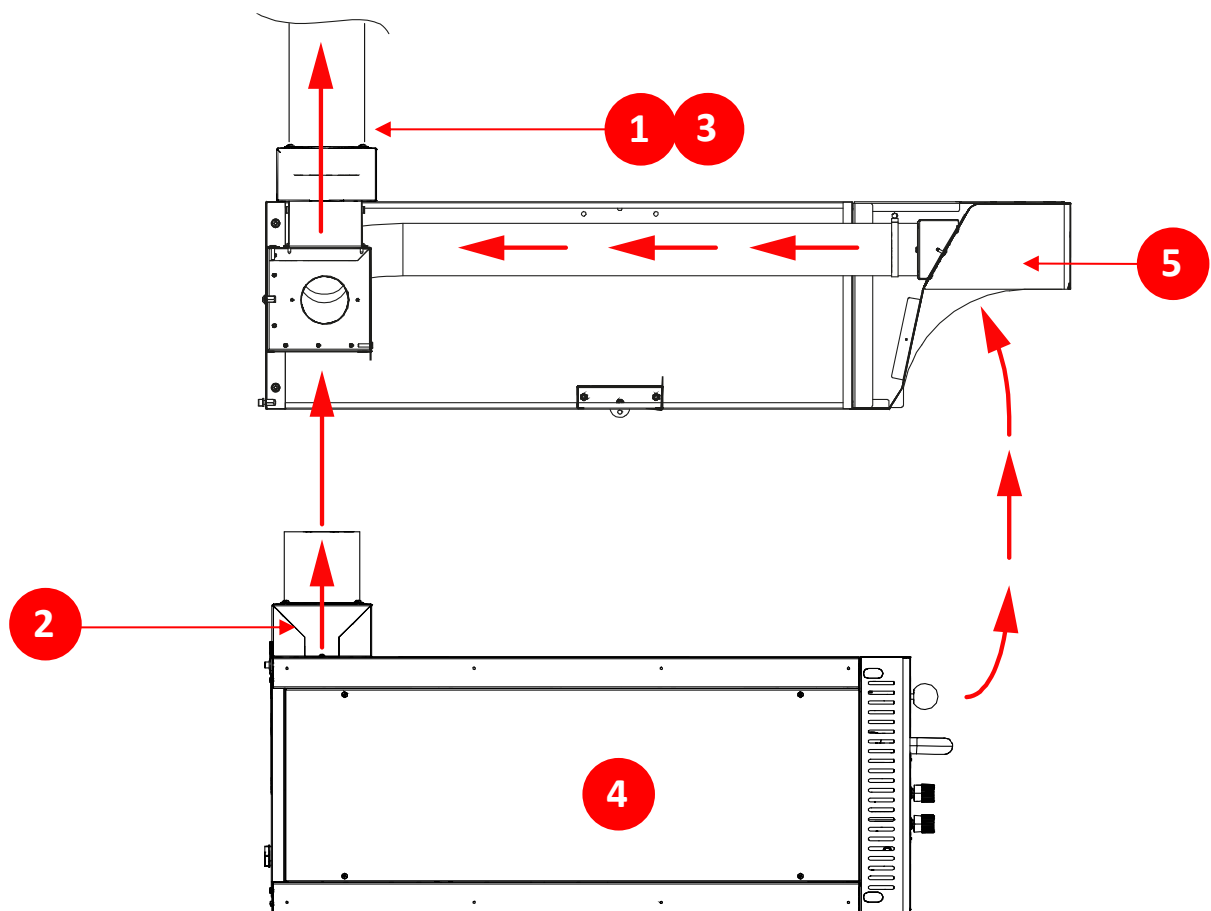

POS.	DESCRIZIONE
1	Flue fitting tube
2	Fitting with oven chimney
3	Chimney
4	Oven
5	Front fumes entry

4.7.2 Fumes passage in the motorized cap

Below is the passage of the fumes inside the cap:

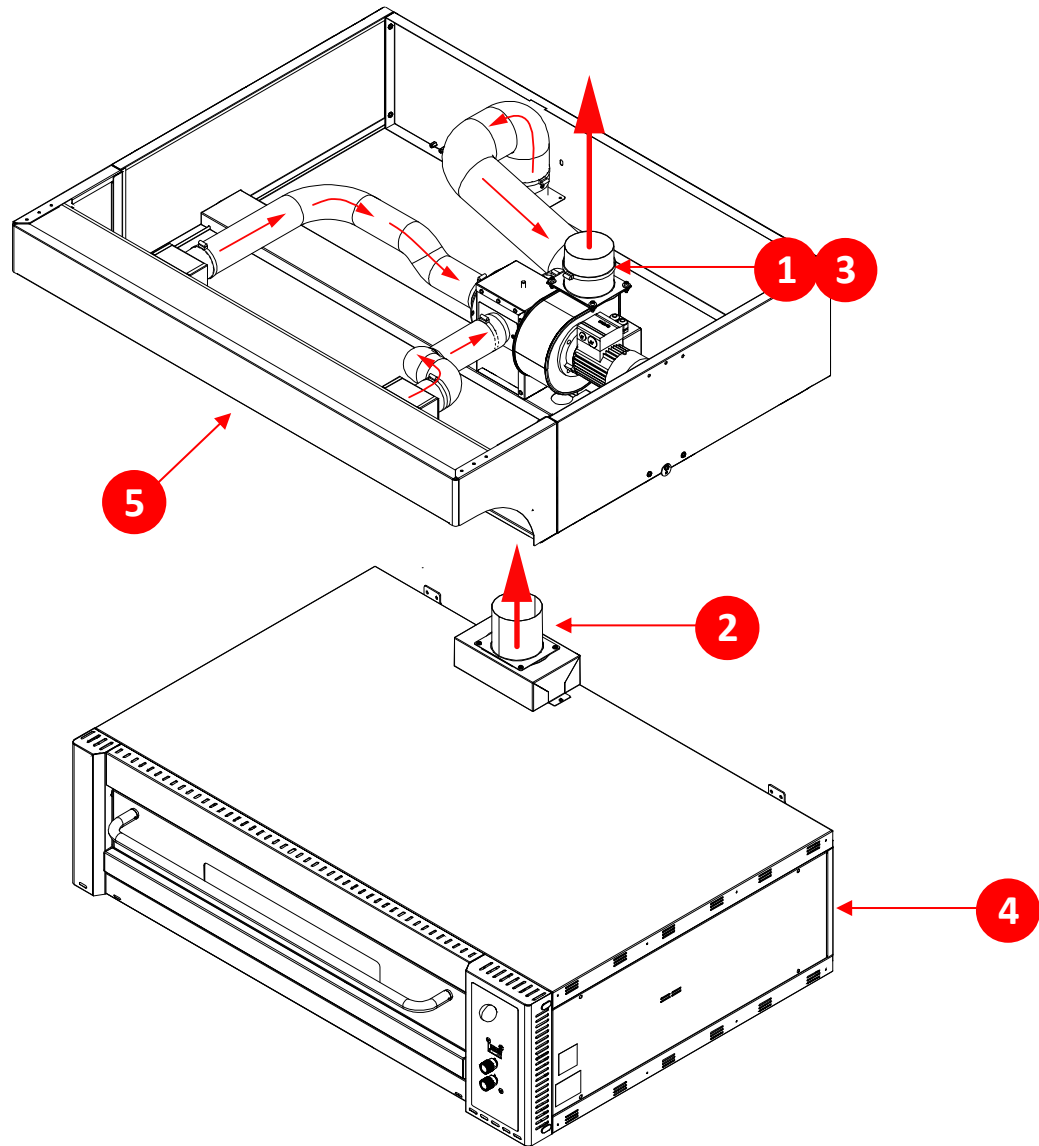

POS.	DESCRIZIONE
1	Flue fitting tube
2	Fitting with oven chimney
3	Chimney
4	Oven
5	Front fumes entry

Chapter 5

TRANSPORT AND INSTALLATION

5 TRASPORT AND INSTALLATION

5.1 Introduction



IMPORTANT!

Lifting and handling operations must be carried out exclusively by specialized and trained personnel who can carry out these activities.

During installation, OEM ALI GROUP S.R.L A SOCIO UNICO technicians must be supported by operators prepared for future maintenance and use of the machine.

The machine is designed so that in the packaging, transport and assembly phases it is necessary to use a forklift or a crane / hoist.

5.2 Packaging

The machine is shipped by OEM ALI GROUP S.R.L A SOCIO UNICO from the factory to the customer.

Depending on the distance of the transport, the customer's specific requests and the residence time of the load in the packaging, the machine is shipped in the following ways:

- normal protective packaging for short and medium distances;
- special protective packaging for long distances.

The shipment must be carried out with covered or sheeted means depending on the type of load.

When receiving the machine, the customer must check that there is no damage caused by the transporter or personnel in charge of specific operations.

- **If there are damages**, leave the packaging in question in the found state and immediately request the damage assessment by the relevant shipping company, then communicate with a certificate of failure the damage detected to the competent transport insurance and to the point of sale.
- **If the oven is in wooden box, on pallets or on wooden brackets** with possible heat-retractable cellophane protection, initially remove the packaging or any cover. To completely free the machine, remove the screws and metal strapping. Then lift the machine with a lifter trolley as described in the appropriate table and remove the pallet used for transport.

5.2.1 Packaging removal

To remove the packaging, follow these steps as described:

STEP	ACTION
1	Place the machine in the place intended for it.
2	Unpack the parts delivered on pallets , as follows: <ul style="list-style-type: none"> • Remove the strapping; • remove the carton; • remove cellophane; • remove any fixing systems to the wooden floor.



IMPORTANT!

Follow the table in paragraph "Group and Weight Division Table" to see which and how many separate parts the machine will be transported.

For the machine handling, refer to section "Transport".

5.2.2 Packaging disposal

The packaging is an integral part of the supply and is not collected, so the disposal is in charge to the buyer.

Any disposal or destruction must take place in accordance with the regulations in the user's country, considering the nature of the materials:

- wooden for boxes;
- Plastic film for the protection of the oven and adhesive tapes for fixing them;
- bags of absorbent substance for dampness.
- Etc.

5.3 Transportation and handling

The OEM ALI GROUP S.R.L A UNICO SOCIO, considering the ways of transport, uses appropriate packaging and fixtures to ensure integrity and storage during transport.

When receiving the machine, verify that no party has been damaged during transport and/or handling.

If damage is found, it is mandatory to report them immediately to the Manufacturer.

The handling activities described in this section must be carried out by qualified personnel for such operations: specially trained personnel to carry out loading, unloading and handling operations by means of lifting.



ATTENTION!

The OEM ALI GROUP S.R.L A SOCIO UNICO is not accountable for the damages, to property or to people, caused by accidents caused by non-compliance with the instructions in this manual.

5.3.1 Group and Weight Division Table

Follow the table below to see which and how many separate parts the oven will be transported to.

GROUP	TYPE	WEIGHT kg (Gross)	DIMENSIONS (mm)
430	NEUTRAL	30	95x116x17
630L	NEUTRAL	32	125x116x17
630S	NEUTRAL	32	95x151x17
930	NEUTRAL	47	125x151x17
430	MOTORIZED	44	95x116x43,7
630L	MOTORIZED	45	125x116x43,7
630S	MOTORIZED	51	95x151x43,7
930	MOTORIZED	63	125x151x43,7
435	NEUTRAL	53	108,3x122,6x31,6
635L	NEUTRAL	57	146x122,6x31,6
635S	NEUTRAL	55	108,3x157,6x31,6
935	NEUTRAL	59	146x157,6x31,6
440	NEUTRAL	56	116,8x132,6x31,6
640L	NEUTRAL	61	158,8x132,6x31,6
640S	NEUTRAL	59	116,8x174,6x31,6
940	NEUTRAL	63	158,8x174,6x31,6
435	MOTORIZED	61	108,3x122,6x31,6
635L	MOTORIZED	65	146x122,6x31,6
635S	MOTORIZED	63	108,3x157,6x31,6
935	MOTORIZED	67	146x157,6x31,6
440	MOTORIZED	64	116,8x132,6x31,6
640L	MOTORIZED	69	158,8x132,6x31,6
640S	MOTORIZED	67	116,8x174,6x31,6
940	MOTORIZED	71	158,8x174,6x31,6

5.3.2 Transport operations



ATTENTION!

OEM ALI GROUP S.R.L A SOCIO UNICO takes no responsibility for any damage **to** the machine **resulting** from non-compliance with **the instructions** provided.



IMPORTANT!

Lifting personnel must be authorised and trained in the use of lifting equipment and must comply with the requirements for individual protection.

TRANSPORT BY FORKLIFT	
Operator qualification	Conductor of lifting means
Necessary DPI	
Lifting means	Forklift
Tools to use	Nothing



ATTENZION!
Use only suitable and approved lifting means, compatible for the size and weight of the machine.



ATTENTION!
Make sure no one is under and within the range of the lifting mean.

To successfully transport **by forklift**, follow these steps:

STEP	ACTION
1	Place the fork of the forklift under the worktop of the machine.
2	Ensure that the fork comes out from the back of the load (at least 5 cm), for a sufficient length to eliminate any risk of overturning the transported part.
3	Lift the forks until the contact with the load Note: If necessary, attach the load to the fork with clamps or similar devices.
4	Slowly lift the load by a few tens of centimeters and check its stability by making sure that the load center of gravity is positioned in the center of the lift fork.
5	Tilt the forks backwards (towards the driver's seat) to ensure greater load stability during transport.
6	Adjust transport speed based on pavement and load type, avoiding abrupt manoeuvres.

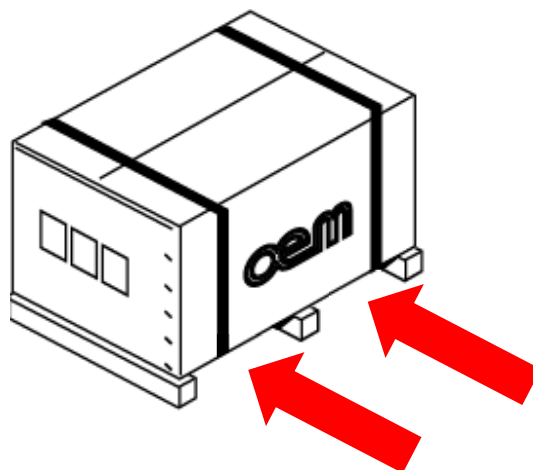

5.4 Installation

5.4.1 Predisposition charced to the customer

Except for any different contractual agreements, it **is normally charged to the customer** the predisposition:

- **Locals** (including masonry works, such as foundations or funnels if required, lighting);
- **power systems** up to the power points of the machine, in accordance with the rules in the country of installation and/or required by the Manufacturer. All technical specifications required by the manufacturer are contained in the sales agreement. The Manufacturer disclaims any liability if the customer fails to guarantee the technical characteristics of the electrical system required in the sales contract.
- The **power supply for the machine**, including the grounding conductor, according to the characteristics and tolerances required and specified in this manual.
- **tools and supplies** needed for assembly and installation;
- **appropriate lifting** and handling equipment.

ATTENTION!



The electrical power cables are paid by the customer and must be sized according to the maximum current absorbed.

Use a flexible cable under an oil-resistant sheath that should not be lighter than polychromelene or synthetic elastomer cables under equivalent sheath (designation 60245 IEC 57).

5.4.2 Allowed environmental conditions

The environment where the machine is installed and used is internal, protected from weather such as: rain, hail, snow, fog, suspended dust, combustible powders, protected from aggressive agents such as corrosive vapors or excessive heat sources and should not be classified as ATEX.

The use of the machine under conditions other than those listed is not allowed.

In particular, the installation and usage environment must not present:

- Exposure to corrosive fumes;
- Exposure to excessive humidity (over 85%) and rapid changes of relative humidity (over 0.005 p.u./h);
- Exposure to excessive dust;
- Exposure to abrasive dust;
- Exposure to oily vapours;
- Exposure to explosive mixtures of dust or gas;
- Exposure to brackish air;
- Exposure to vibrations, shocks or abnormal shocks;
- Exposure to bad weather out of the permitted limits or dripping;
- Exposure to unusual transport or storage conditions;
- Exposure to high or rapid thermal variations (over 5K/h);
- Presence of nuclear radiation.

The machine is designed and built to operate, safely, under the following environmental conditions:

Room temperature	15 – 35 °C
Maximum relative humidity	90 %
Place of installation	Restaurant
Lighting	Neon or LED light
Support surface	Any floor that can support its weight



ATTENTION!

Environmental conditions other than those specified can cause serious damages to the machine. The positioning of the machine in environments that do not correspond to what is indicated causes the expiry of the warranty.



IMPORTANTE!

The work surface must be sufficiently illuminated. If there are shadows or differences in height, it will be up to the user to set up appropriate lighting devices.

If these requirements are not met, the Manufacturer disclaims any responsibility.

5.4.3 Cap positioning



DANGER!

The hood **SHOULD NOT BE INSTALLED** close to flammable walls such as furniture, partitions, bead coatings, etc.



IMPORTANT!

The manufacturer denies any responsibility for fires to people or things arising from non-compliance with these provisions.

For the positioning of the oven:

1. place the cap on the oven in accordance with the indications indicated in the figure as they indicate the minimum distances necessary for the optimal operation of the cap.

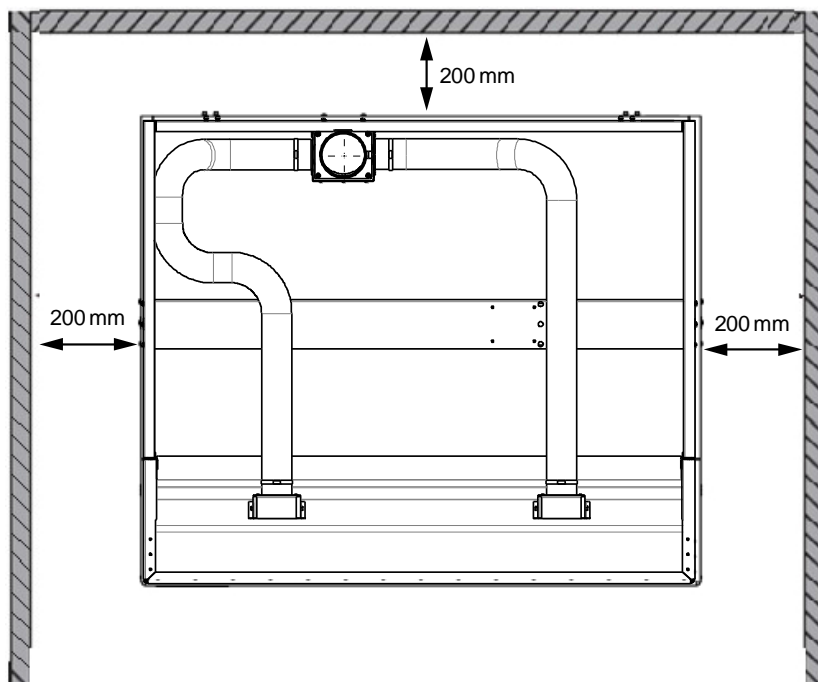

5.4.4 Neutral/motorized cap assembly (model 30)

On the following pages we show the indications for the assembly of the cap.

Required DPI	
Lifting mean	Forklift / Crane / Hoist
Tools to use	-

To assemble the cap, follow these steps:

STEP	ACTION
1	Place the cap on top of the oven paying attention to the correct alignment of the cap and oven.
2	Fix the cap to the oven by screwing the screws positioned laterally (pos.1)
3	Connect a tube of 120mm to the fume outlet (pos.2) and connect it to the flue.

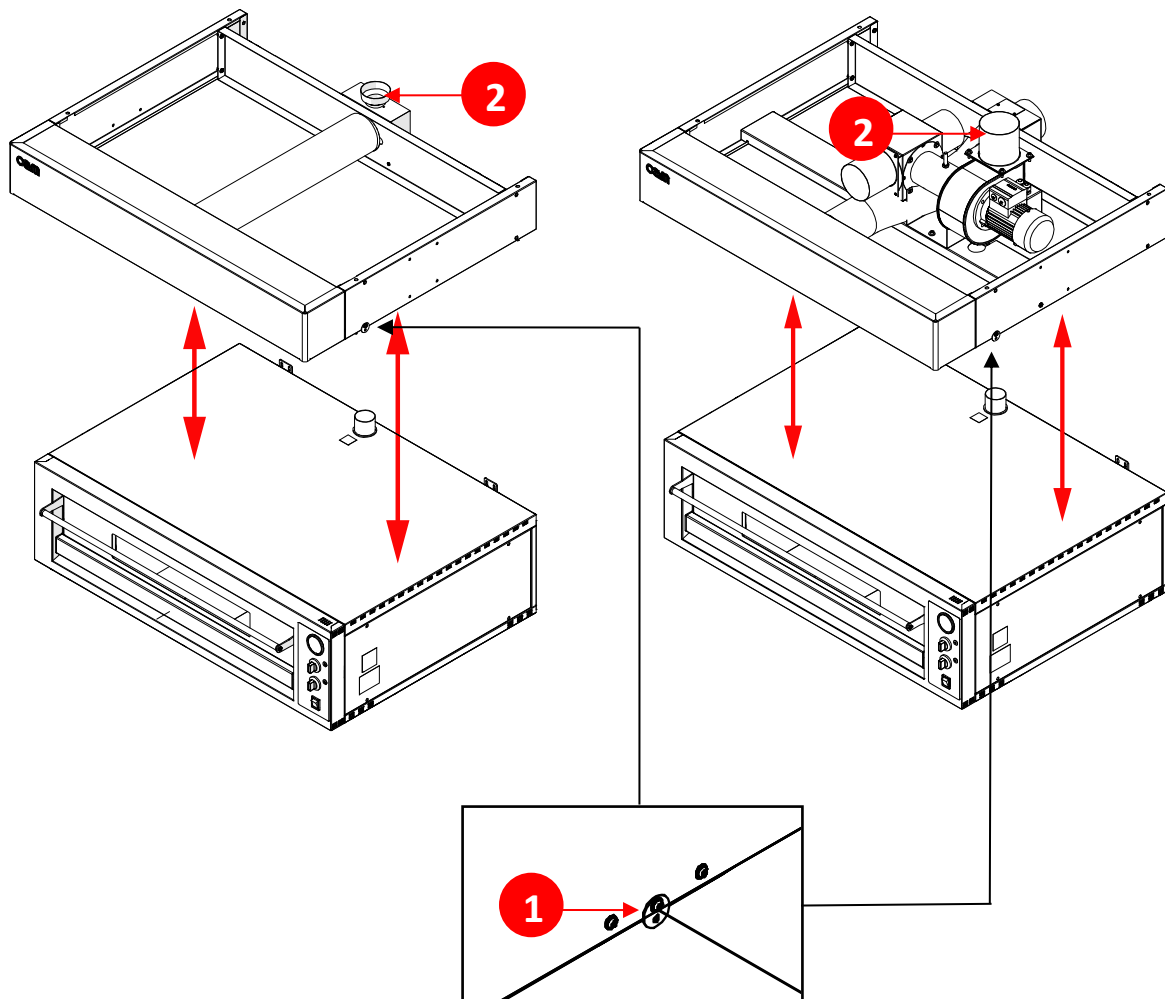

5.4.5 Neutral cap assembly (model 35/40)

On the following pages we show the indications for the assembly of the cap.

Required DPI	
Lifting mean	Forklift / Crane / Hoist
Tools to use	-

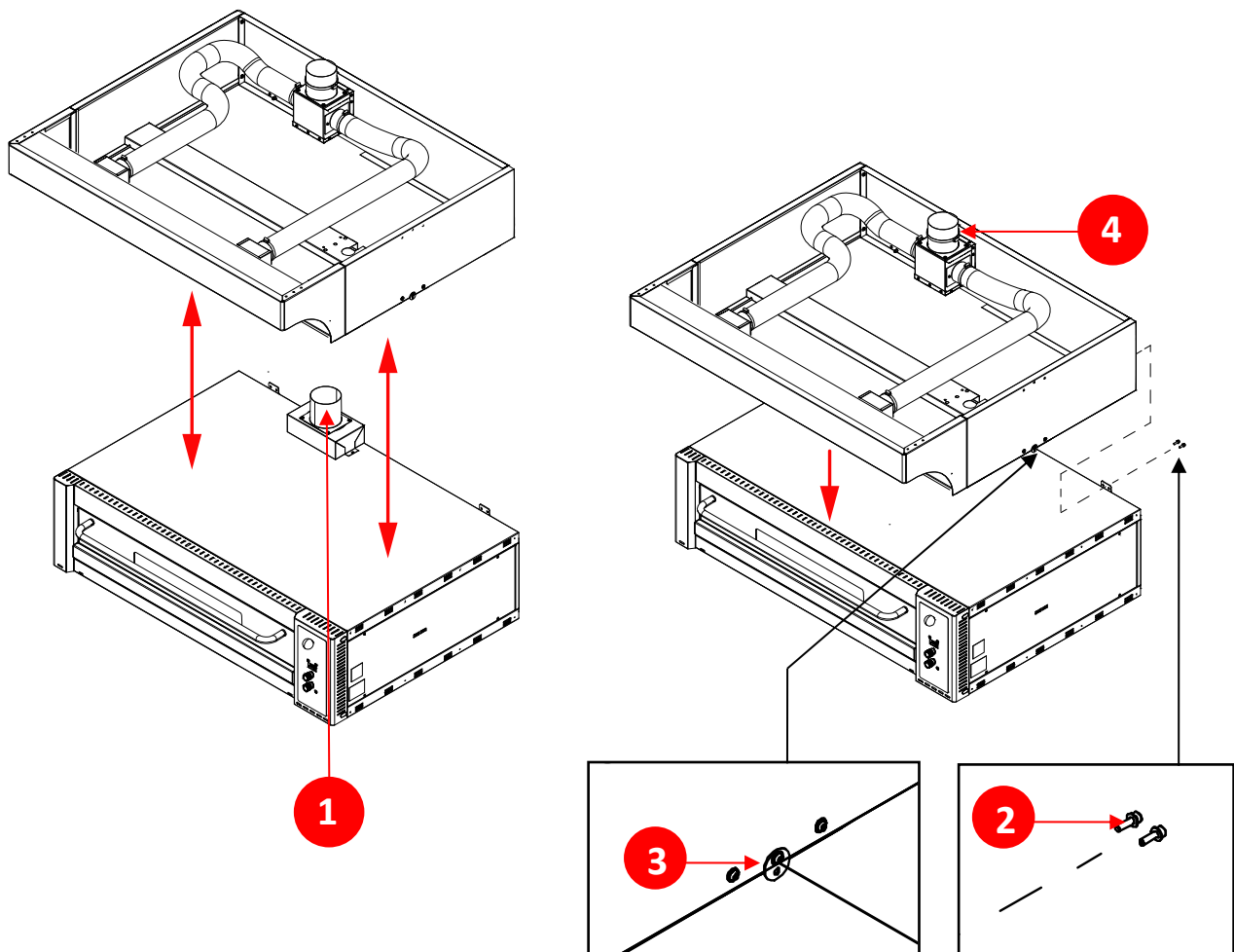

To assemble the cap, follow these steps:

STEP	ACTION
1	Place the cap on top of the oven, paying attention to the correct alignment of the cap and oven, and the coupling of the fume outlet pipe from the oven (pos.1) to the cap.
2	Secure the cap on the oven by screwing 4 rear screws (pos.2), and the screws placed on the side (pos.3)
3	Connect a 120mm tube to the fume outlet (pos.4) and connect it to the flue.



5.4.6 Motorized cap assembly (model 35/40)

The following pages show the indications for the assembly of the cap.

Required DPI	 
Lifting mean	Forklift / Crane / Hoist
Tools to use	-

To assemble the cap, follow these steps:

STEP	ACTION
1	Remove the flange (pos.1) with its fume outlet grafting tube.
2	Place the cap on top of the oven paying attention to the correct alignment of the cap and oven. Screw the flange (pos.2) of the baked fume extraction tube.
3	Fix the hood to the oven by screwing n°4 rear screws (pos.3) and the screws positioned laterally (pos.4)
4	Connect a 120mm tube to the fume outlet (pos.4) and connect it to the flue.

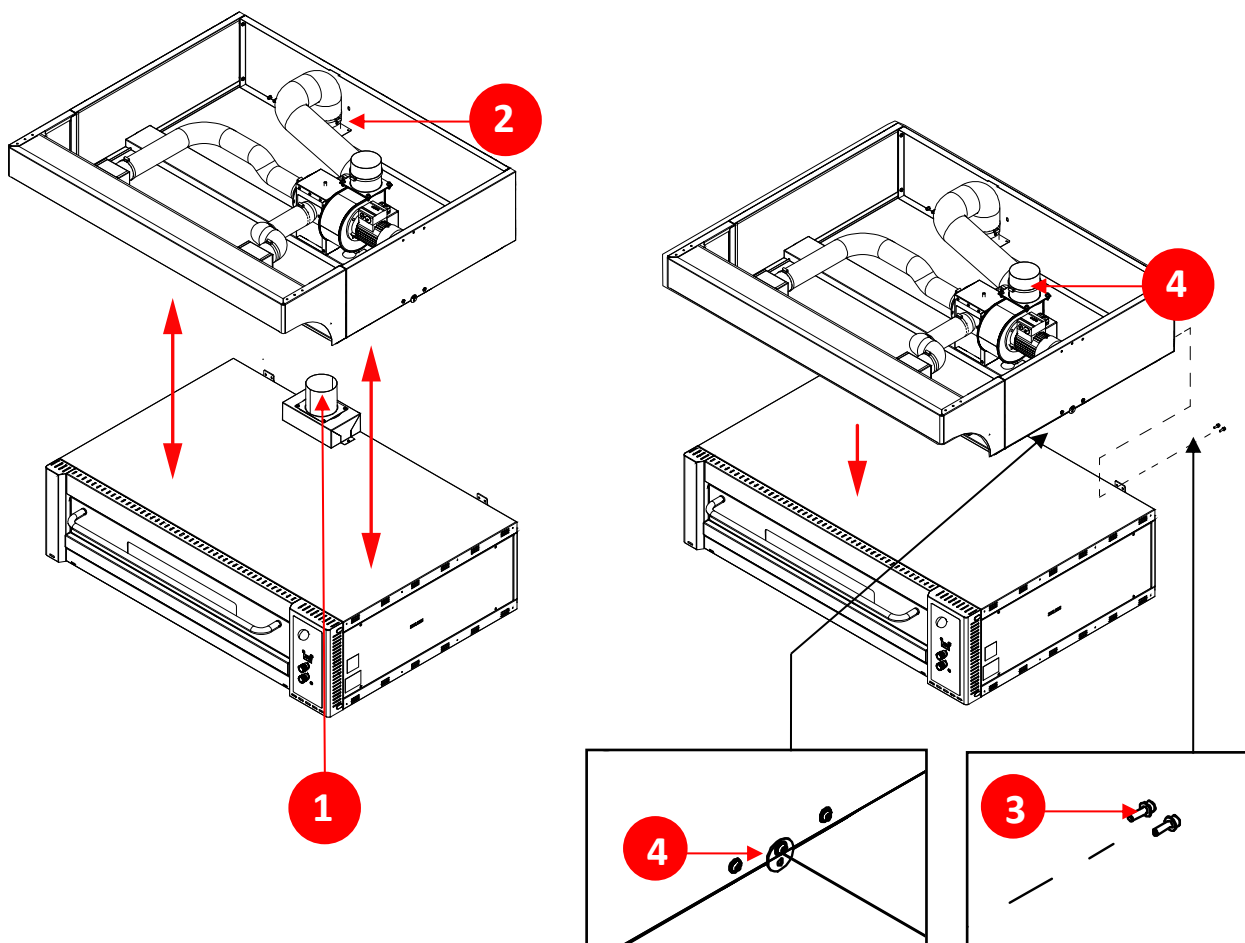

5.5 Connections

For the starting of the oven, the necessary connections to local networks must be ensured:

- **electrical connection** (including grounding connection),

compliant with the rules in the country of installation.

It is the user's responsibility to ensure the required connection features.



ATTENTION!

The required connection must be made by qualified and authorised personnel.

5.5.1 Electrical connection

ATTENTION!

The electrical power cables are charged to the customer and must be sized according to the maximum current absorbed.



Use a flexible cable under an oil-resistant sheath that should not be lighter than polychromelene or synthetic elastomer cables under equivalent sheath (designation 60245 IEC 57).



ATTENTION!

Before performing any electrical connection operation, it is important to check that the machine is turned off. Then place the general switch on "0" - "OFF".



ATTENTION!

Ensure that the customer power line has been pre-dissected.

The connection between the oven and the grounding system is up to the buyer.



ATTENTION!

The operation must be performed exclusively by specialized and authorized personnel (electric maintainer).

Before proceeding with **the electrical connection**, make sure that:

- the maintainer is aware of the regulations in the country of installation;
- the frequency and power voltage values of the machine match the values of the power supply;
- the section of the used electrical cables is adequate for absorption;
- the power line is adequate to withstand the maximum absorptions of the oven;
- the grounding of the circuit complies with **EN 60204-1** standards;
- materials used in the grounding system have adequate solidity or adequate mechanical protection.



ATTENTION!

Do not operate with hands and damp objects.

In the event of a fire, do not use water on electrical components.



IMPORTANT!

The electrical connection is provided with a cable, which must be connected to the power grid by specialized personnel (electrician).

IMPORTANT!



The cap must be connected to a general omnipolar switch that interrupts all contacts including neutral, with distance between open contacts of at least 3mm, with magnetothermic safety fuses or with protective fuses. In addition, the general switch must be located in the vicinity of the device and easily accessible.

Chapter 6

CONTROLS AND USE

6 CONTROLS AND USE

The machine does not require the continuous presence of an operator during operations.



ATTENTION!

Using the oven for a different purpose than those indicated by the manufacturer may cause serious harm to people and/or things and/or animals.

OEM ALI GROUP S.R.L A SOCIO UNICO is not responding for damages caused by improper use of the machine.



IMPORTANT!

The control panel is not part of the area in contact with the food and therefore the appropriate precautions must be taken to AVOID the operator cross-contact with the food and controls.

6.1 Operator positioning

The operator, during the operation of the machine is positioned frontally, so as to be able to insert the products and rear to easily remove the products (Pos. "1").

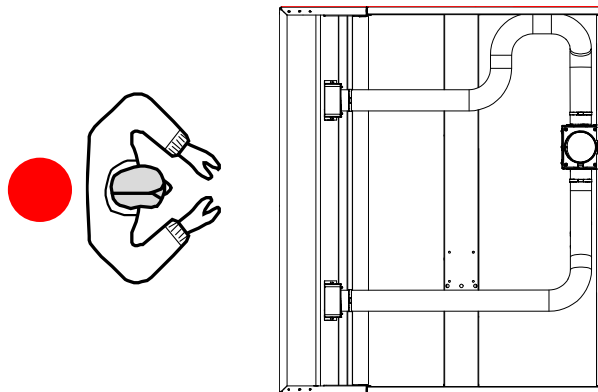

IMPORTANT!

THE FLOOR NEAR THE MACHINE COULD BE SLIPPERY, EQUIP YOURSELF WITH ADEQUATE ANTI-SLIP SHOES.

6.2 Motorized cap control buttons

the buttons are described below.

POS.	BUTTON	DESCRIPTION
1	Power button	Pressing the button starts the suction hood.
2	Speed adjustment	By turning the knob, the suction speed is increased/decreased. NOTE: Turn the knob to about half-stroke for optimal use.

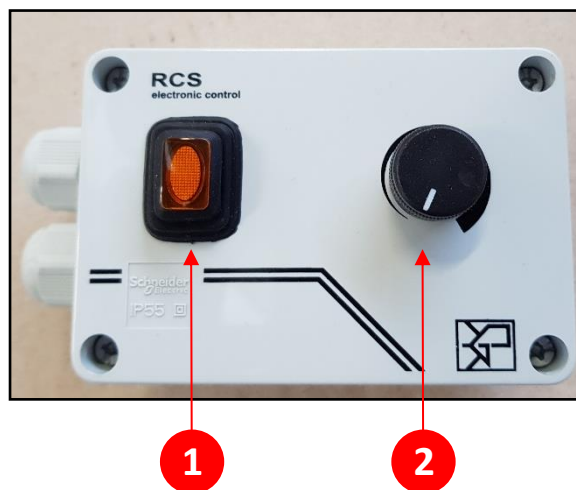

IMPORTANT!

Always keep the hood on while using the oven, in order to ensure good operation and good baking.

6.3 How to use it

6.3.1 Preliminary checks

Before proceeding with the start up of the oven, you must perform the following checks:

- Check that the oven is positioned on a top able to support its weight.
- Check that the space around the oven is free of obstructions.
- Check that the oven has been connected to the power grid.
- Check that the electrical power supply phases are correct.
- Check that the oven is not in a **"Maintenance"** state.

6.3.2 Startup procedure

To turn on the **machine**, proceed as described:

STEP	ACTION
1	Place the general on/off switch, upstream of the machine, on "ON" .
2	Press the power on/off button. (see paragraph "Command button").
3	Adjust speed.

6.3.3 Turning off procedure

To turn off the **machine**, proceed as described:

STEP	ACTION
1	Press the power on/off button (see paragraph "Operator Panel") to stop the machine.
2	Place the general on/off switch, upstream of the machine, on "OFF" .

Chapter 7

MAINTENANCE

7 MAINTENANCE



ATTENTION!

Maintenance operations must be performed when the equipment is turned off (main switch placed on "0"- "OFF").



ATTENTION!

Maintenance operations must be performed by qualified and authorized staff.



IMPORTANT!

When removing the plug, the operator must be able to check that the plug is indeed disconnected from any spot he has access to.

Maintenance of the equipment includes all operations (inspection, verification, check, adjustment and replacement) that it is necessary to perform following its normal use.

For good maintenance:

- Only use original spare parts, as well as suitable tools in a good state.
- Follow the maintenance frequency guidelines provided by the user manual for planned maintenance (preventive and periodic). The time lapse (calculated either in time or in work cycles) between one intervention and the following one must be regarded as the longest possible; therefore, it cannot be exceeded, but it can be shortened.
- Good preventive maintenance requires constant attention as well as a continuous monitoring of the equipment. Promptly check the cause of any anomaly such as excessive noise, overheating, etc... and solve it.
- A prompt removal of what is provoking an anomaly or malfunction avoids further damage to the equipments and guarantees the operators' safety.

The staff in charge of the equipment's maintenance must be well trained and must have deep knowledge of accident prevention regulations; unauthorized staff must remain outside the working area during operations.

Also the equipment cleaning operations must be performed only during maintenance, when the equipment is still and de-energized.



IMPORTANT!

Do not perform any operation if you are unsure about anything. Contact the manufacturer first to get the needed explanations.



ATTENTION!

All kinds of repair and maintenance which are not included in this user manual can only be performed provided they have been previously authorized by OEM ALI GROUP S.R.L A SOCIO UNICO. OEM ALI GROUP S.R.L A SOCIO UNICO shall not be held responsible for any damage to people or objects, if resulting from operations either different from those described or performed differently from what stated.

From an operational point of view, maintenance operations of this equipment can be divided in two main categories:

Ordinary Maintenance	All operations that the service people must perform preventively in order to guarantee the proper functioning of the equipment over time; ordinary maintenance includes inspections, check, adjustment, cleaning and lubrication.
Extraordinary Maintenance	All operations that the service people must perform when needed by the equipment. Extraordinary maintenance includes operations of revision, repair, recovery of the nominal functioning conditions or replacement of a unit if damaged, faulty or worn out.

7.1 Safety Warnings



ATTENTION!

Before starting any maintenance operation, disconnect the equipment from the power supply.



ATTENTION!

When removing the plug, the operator must be able to check that the plug is indeed disconnected from any spot he has access to.



ATTENTION!

When the equipment is under maintenance, in order to prevent it from being accidentally switched on, disconnect power supply and add the following notice:

"ATTENTION! EQUIPMENT UNDER MAINTENANCE "

The accident prevention regulations contained in this paragraph must always be strictly followed, during maintenance of the equipment, so as to avoid injuries to the staff and damages to the equipments.

- Maintenance must only be performed when the equipment is switched off and de-energized.
- Put specific warnings such as: **EQUIPMENT UNDER MAINTENANCE – DO NOT SUPPLY POWER** next to the equipment itself.
- Only perform maintenance operations (Mechanical, Electrical, Fluidic) you have been previously authorized to perform.
- You must be able to use the most suitable and adequate tools to identify the failure and you must be aware of which the most suitable tools are to perform maintenance operations.

7.2 Ordinary Maintenance

When the equipment is delivered to the user, it is already adjusted so as to work properly; however, in order to guarantee its good functioning over time, you must perform controls as well as preventive and recurring maintenance operations.

Ordinary maintenance includes inspections, checks and operations that prevent failures by monitoring:

- the mechanical status of the equipment;
- the (electric) power sources;
- the equipment cleanness.

The following charts list a series of controls and interventions to be performed according to a suggested timing. The recurrence of the ordinary maintenance operations listed is meant for normal functioning conditions, that is, within the provided conditions of use.

7.2.1 Cleaning



ATTENTION!

Cleaning must be performed only by qualified and authorized staff.



ATTENTION!

Respect the regulations in force in the country where the equipment is installed as far as washing water treatment is concerned.



IMPORTANT!

When removing the plug, the operator must be able to check that the plug is indeed disconnected from any spot he has access to.

7.3 Extraordinary Maintenance

ATTENTION!



Extraordinary maintenance, as well as repair of the equipment, are to be performed only by qualified, trained and authorized technicians, either working for the Manufacturer or for an authorized service center.

These operations require deep, specialized knowledge of the equipment, of the necessary interventions to perform, of the relevant risks and of the correct procedures to work in complete safety.

In case of exceptional events requiring extraordinary maintenance, the regular service people working for the user must proceed as follows:

- check the status of the damaged and/or dephased units;
- perform the operations listed in this paragraph;
- if the operations to perform are not listed in this manual, send the Manufacturer a report of the events that occurred, the results of the inspection and other useful information.

The Manufacturer or the authorized Service Center will assess the situation and will agree with the service people upon the kind of intervention to perform, choosing the best solution among the following two:

- the Manufacturer sends an authorized, trained and qualified technician to perform the necessary operations;
- the Manufacturer authorizes the user's service people to perform the operations, and sends them further instructions, if needed.

ATTENTION!



The needed spare parts must be ordered to OEM ALI GROUP S.R.L A SOCIO UNICO. In case the customer does not use spare parts either original or authorized in writing by the Manufacturer, the latter shall not be held responsible about the equipment's functioning and the workers' safety. The authorization and/or the instructions must always be transmitted in writing. Without a written authorization, it is forbidden to proceed and the Manufacturer refuses all responsibility.



ATTENTION!

In case it is necessary to perform operations of extraordinary maintenance, contact the Manufacturer.

PAGINA LASCIATA INTENZIONALMENTE BIANCA

Chapter 8

PUTTING THE EQUIPMENT OUT OF ORDER AND DISPOSING OF IT

8 PUTTING THE EQUIPMENT OUT OF ORDER AND DISPOSING OF IT



ATTENTION!

Only qualified staff can take care of dismantling and putting out of order the equipment. In particular, only the person in charge of the dismantling phase and of end-of-life disposal is allowed to:

- perform operations of mechanical and electrical disconnection of the units according to the dismantling instructions and the project schemes;
- take the units to the disposal center in order to divide the different materials.

The equipment is basically made up by the following materials:

- ferritic steel (AISI 430);
- steel (DD11);
- aluminates (DX51D + AS);
- plastic material in polyethylene;
- elastomers, PTFE, graphite;
- electric cables and their sheaths;
- etc...



ATTENTION!

The equipment does not contain dangerous components or substances which need particular removal procedures.

8.1 Putting the equipment out of order and storing it

If the equipment **will not be used for a long time**, it is necessary to secure and store it. Proceed as follows:

STEP	ACTION
1	Disconnect power supply from the equipment.
2	Cover the equipment and store it in a place which must be under cover and not too damp.

8.2 Disposal

When you intend to **dispose of the equipment**, you must make sure to secure it. Proceed as follows:

STEP	ACTION
1	Disconnect power supply from the equipment.
2	Proceed with dismatling, separating the components making up the equipment in groups ready for differentiated disposal.



ATTENTION!

To disassemble commercial parts or subcontracting material making up the equipment supplied by OEM ALI GROUP S.R.L A SOCIO UNICO, please refer to the relevant user manual supplied.



According to the **“WEEE” Directive 2012/19/EU**, if the component/equipment purchased is marked with this symbol of a crossed-out rubbish bin with wheels, it means that, at the end of its useful life, the product must be collected separately from the other waste.



ATTENTION!

Always respect the disposal regulations in force in the country where the equipment is installed.

PAGINA LASCIATA INTENZIONALMENTE BIANCA

Chapter 9

ATTACHMENTS

9 ATTACHMENTS

Attachment list

1 ELECTRICAL DIAGRAMS

Electrical diagram OM23.00541

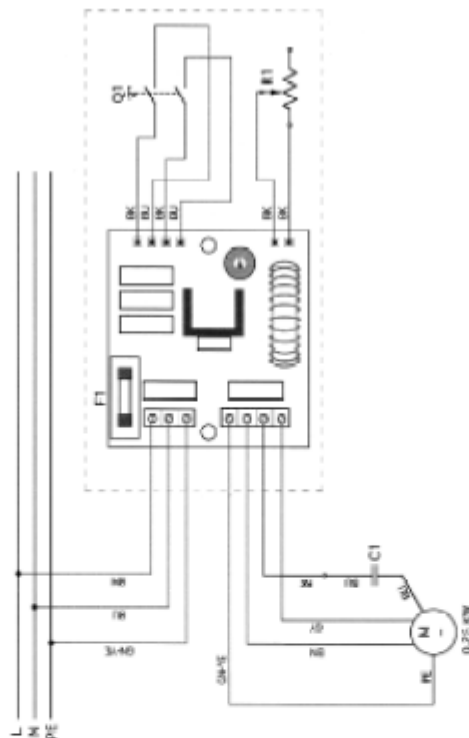

F1 FUSIBILE 5A
FUZE 5A
FUSIBLE 5A
SICHERUNG 5A
FUSIBLE 5A

Q1 ITERRUTTORE
SWITCH
INTERRUPTEUR
SCHALTER
INTERRUPTOR

R1 POTENZIOMETRO
REGULATOR
REGULATEUR
REGLER
REGULATOR

M MOTORE 0,25 KW
DRIVE 0,25 KW
MOTEUR 0,25 KW
MOTOR 0,25 KW
MOTOR 0,25 KW

C1 CONDENSATORE
CONDENSATION
CONDENSATION
KONDENSIERUNG
CONDENSACION

